

Features

- Intel® Atom™ x5-Z8350 Processor: 2M Cache, up to 1.92 GHz
- 2GB / 4GB RAM, 32GB / 64G eMMC
- PCAP Touch
- 10/100/1000 Ethernet (PXE Boot)
- Touch button (Power/ Brightness/ Volume/ LED)
- RS232 or RS422 or RS485
- DC 12~24V Input or Powered LAN 802.3AT
- NFC Reader, A-MIC
- 2.0MP Camera
- Speak 4Ω 2.0W/2.5W(MAX)
- LED Indicating Light Bar (Light color: Green and Red, Illuminating area: 70*8mm (front), 70*5mm (side))
- 75 x 75mm VESA Mount
- Antibacterial Plastic



Specifications

| System | |
|------------------------|---|
| CPU | Intel® Atom™ x5-Z8350: 2M Cache, up to 1.92 GHz |
| System Memory | 2GB / 4GB DDR3L RAM |
| Wireless Communication | 802.11 b/g/n |
| Storage | 32GB eMMC / 64GB eMMC |
| OS Information | Windows 10 IoT (64 bit) Android 5.1 (64 bit) Ubuntu 19.04 (64bit) |
| Panel | |
| LCD Size | 10.1" |
| Resolution | 1280x800 |
| Luminance | 350 cd/m2 |
| Viewing angle | 170° (H/V) |
| Touch Type | PCAP |
| Display | |
| Resolution | LVDS: Max. resolution 1280x800 @ 60Hz |
| Multiple Display | Windows support extended mode |
| Data Collection | |
| Camera | 2M pixel |
| NFC | NFC Reader |
| Audio | |
| Speaker | 2 x speaker (L & R) |
| Speaker Output | 4Ω 2.0W/2.5W(MAX) |
| Ethernet | |
| Chipset | Realtek RTL8111H(S)-CG |
| LAN Port | 1 x RJ45 |

| I/O | |
|----------------------------|--|
| USB | 2 x USB 2.0 |
| Camera | 2.0MP Camera |
| External I/O Connector | 1 x RJ45 for RS232 or RS422 or RS485 2 x USB 2.0 Type A 1 x 10/100/1000 Ethernet 1 x 4-Pin 3.5mm Audio Jack |
| Internal I/O Connector | 1 x Touch Button interface 1 x eDP & Dual channel 24bit LVDS 1 x I2C interface for PCAP 5 x USB interface for PCAP, Camera and others 1 x Micro USB2.0 client (reserved) 1 x Micro SD connector 2 x LED Bar interface 1 x A-MIC |
| Camera | 2.0MP Camera |
| Power Requirement | |
| Power Requirement | DC Input, 12~24V |
| Power Type | DC Jack |
| Adapter | Input: 100~240 Vac/50~60 Hz Output: 60W Adapter (12V @ 5A Adapter) |
| Mechanical and Environment | |
| Operating Temp | 0°C ~ 40°C (32°F ~ 104°F) |
| Storage Temp | -10°C ~ 60°C (14°F ~ 140°F) |
| Operating Humidity | 40°C @ 95% Relative Humidity, Non-condensing |
| Weight | 2.43 lbs/ 1.1 Kgs |
| Dimension | 10.63" x 7.6" x 1.1" (270 x 193 x 28 mm) |
| Mounting | VESA 75x75mm |
| Certification | CE FCC Class B |
| Reliability | Vibration Test, Shock Test, Drop Test: please check information in the Manual |

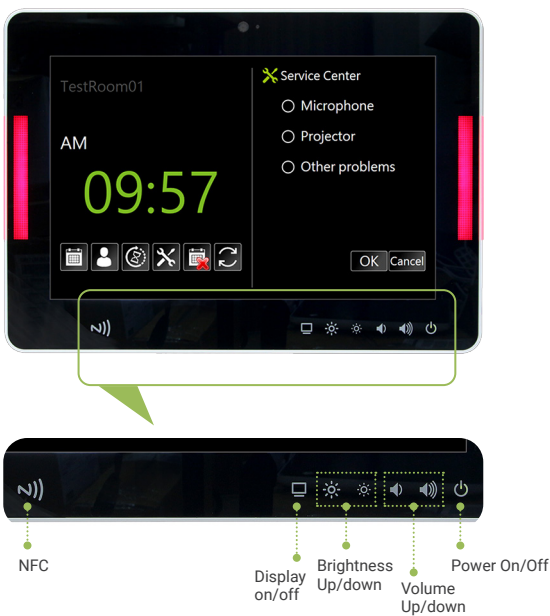
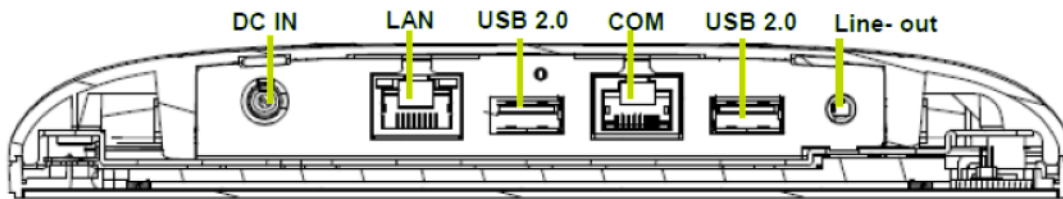

Ordering Info

| | |
|------------------|--|
| VNS-10W01-32G-WN | 10" Panel PC, Intel Atom Z8350 Processor 2GB DDR3L, 32GB eMMC, DC12~24V, Windows 10 IoT 2019 |
| VNS-10W01-64G-WN | 10" Panel PC, Intel Atom Z8350 Processor 4GB DDR3L, 64GB eMMC, DC12~24V, Windows 10 IoT 2019 |
| VNS-10W01-32G-LX | 10" Panel PC, Intel Atom Z8350 Processor 2GB DDR3L, 32GB eMMC, DC12~24V, Linux OS |
| VNS-10W01-32G-AN | 10" Panel PC, Intel Atom Z8350 Processor 2GB DDR3L, 32GB eMMC, DC12~24V, Android 5.1 OS |

* All product specifications and images are subject to change without notice. Last update: 2021/04/09

